

## TrueSize® Carbide Range Reamer Straight Flute Series 270

## TrueSize® Carbide Range Reamer Left Hand Spiral Series 270L



Before you order a 270 Series - check our listing of standard diameters in the 272 Series.

Competitors special sizes are our standards!

Recommended for general purpose reaming in most materials. Kept in stock as a semi-finished tool. When orders are received tools can be promptly finish ground to the desired diameter. Specify size when ordering.



Series 270

Series 270L

- Reamer Diameter  $\leq .0433"$  (1.09mm) = No Centers.
- Reamer Diameter  $.0434" - .1280"$  (1.10mm - 3.25mm) = Male Centers.
- Reamer Diameter  $\geq .1281"$  (3.26mm) = Female Centers.
- All Diameters with Male Centers, Chamfer Angle =  $42^\circ - 44^\circ$  per side.
- All Diameters without Male Centers, Chamfer Angle =  $44^\circ - 46^\circ$  per side.

### Right Hand Cutting

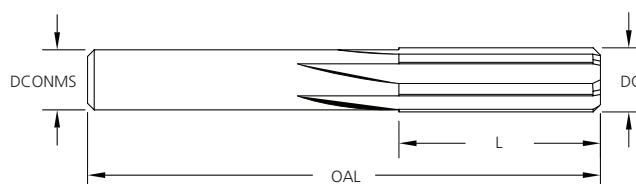

Inch	
DC	Tolerance
$\leq 3/8$	$+0.001/+0.0003$
$> 3/8$	$+0.001/+0.0004$
DCONMS	Tolerance
$\leq 3/8$	$+0.000/-0.001$
$> 3/8$	$+0.000/-0.001$
OAL	Tolerance
$\leq 3/8$	$\pm 1/16$
$> 3/8$	$\pm 1/16$
L	Tolerance
$\leq 3/8$	$\pm 1/16$
$> 3/8$	$\pm 1/16$

Metric (mm)	
DC	Tolerance
$\leq 9.52$	$+0.0025/+0.0076$
$> 9.52$	$+0.0025/+0.0102$
DCONMS	Tolerance
0.35 - 3.15	$+0/-0.03$
OAL	Tolerance
0.35 - 3.15	$\pm 1.5$
L	Tolerance
0.35 - 3.15	$\pm 1.5$

### Need a Reamer Fast?

Request Rapid Turn Around Service.  
Straight Flute sizes above  $.0433"$  (1.10mm)  
Contact Customer Service For Delivery Times.  
*25 piece maximum.*

