

Edge Hog® - Series SA - Inch

Includes Micro Sizes

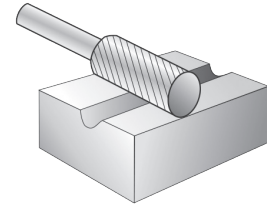

Cylindrical Flat End

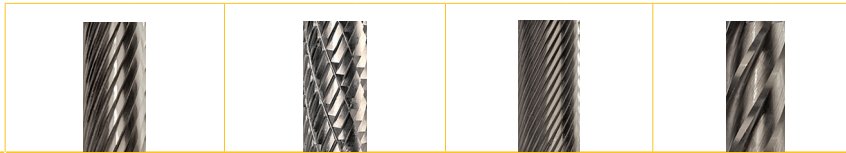
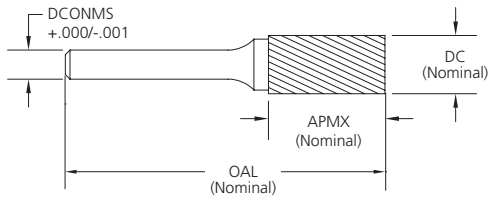

Specify type of cut when ordering.*

SCTI	Type of Cut								DC	DCONMS	OAL	APMX
	Single		Double		Fine		Shear					
	Tool No.	EDP	Tool No.	EDP	Tool No.	EDP	Tool No.	EDP				
SA-41	69000020	69001	69000027	69009	69000030	69017			1/16	1/8	1-1/2	1/4
SA-42	69020020	69049	69020027	69057	69020030	69065			3/32	1/8	1-1/2	7/16
SA-43	69010020	69025	69010027	69033	69010030	69041			1/8	1/8	1-1/2	9/16
SA-43L3	69010020L3	69801	69010027L3	69803					1/8	1/8	3	9/16
SA-11	41125020	41037	41125027	41049	41125030	41061			1/8	1/4	2	1/2
SA-52	72010020	72001	72010027	72009	72010030	72017			5/32	1/8	1-1/2	1/2
SA-13	41156220	41073	41156227	41085	41156230	41097			5/32	1/4	2	5/8
SA-53	72030020	72049	72030027	72057	72030030	72065			3/16	1/8	1-1/2	1/2
SA-14	41187520	41109	41187527	41121	41187530	41133			3/16	1/4	2	5/8
SA-51	70010020	70013	70010027	70021	70010030	70029			1/4	1/8	2	1/2
SA-1	41250020	41145	41250027	41157	41250030	41169			1/4	1/4	2	5/8
SA-2	41312520	41181	41312527	41193	41312530	41205			5/16	1/4	2-3/4	3/4
SA-3	41375020	41217	41375027	41229	41375030	41241			3/8	1/4	2-3/4	3/4
SA-3NF							41375150	41601	3/8	1/4	2-3/4	3/4
SA-4	41437520	41273	41437527	41285	41437530	41297			7/16	1/4	3	1
SA-5	41500020	41309	41500027	41321	41500030	41333			1/2	1/4	3	1
SA-5NF							41500150	41616	1/2	1/4	3	1
SA-6	41625020	41365	41625027	41377	41625030	41389			5/8	1/4	3	1
SA-6NF							41625150	41631	5/8	1/4	3	1
SA-15	41750120	41457	41750127	41469	41750130	41481			3/4	1/4	2-1/2	1/2
SA-16	41750220	41493	41750227	41505	41750230	41517			3/4	1/4	2-3/4	3/4
SA-7	41750020	41421	41750027	41433	41750030	41445			3/4	1/4	3	1
SA-9	41100020	41001	41100027	41013	41100030	41025			1	1/4	3	1

*Diamond, fine diamond, alternate fine diamond, and chipbreaker cuts are no longer available.



Edge Hog® - Series SA - Metric

Includes Micro Sizes

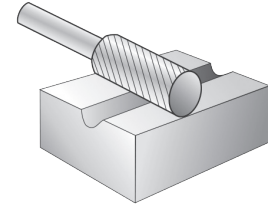

Cylindrical Flat End

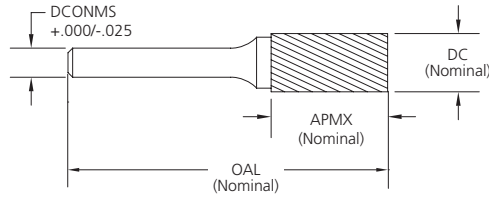

Specify type of cut when ordering.*

Edge Hog® Burs
Series SA

SCTI	Type of Cut								DC	DCONMS	OAL	APMX
	Single		Double		Fine		Shear					
	Tool No.	EDP	Tool No.	EDP	Tool No.	EDP	Tool No.	EDP				
SA-41M	69000020M	69005	69000027M	69013	69000030M	69021			1.6	3.0	38.0	6.0
SA-42M	69020020M	69053	69020027M	69061	69020030M	69069			2.4	3.0	38.0	11.1
SA-11M	41125020M	41045	41125027M	41057	41125030M	41069			3.0	6.0	50.0	12.7
SA-43L76M	69010020L3M	69802	69010027L3M	69804					3.0	3.0	76.0	14.3
SA-43M	69010020M	69029	69010027M	69037	69010030M	69045			3.0	3.0	38.0	14.3
SA-52M	72010020M	72005	72010027M	72013	72010030M	72021			4.0	3.0	38.0	12.7
SA-13M	41156220M	41081	41156227M	41093	41156230M	41105			4.0	6.0	50.0	16.0
SA-53M	72030020M	72053	72030027M	72061	72030030M	72069			4.8	3.0	38.0	12.7
SA-14M	41187520M	41117	41187527M	41129	41187530M	41141			4.8	6.0	50.0	16.0
SA-1M	41250020M	41153	41250027M	41165	41250030M	41177			6.0	6.0	50.0	16.0
SA-51M	70010020M	70017	70010027M	70025	70010030M	70033			6.4	3.0	51.0	12.7
SA-2M	41312520M	41189	41312527M	41201	41312530M	41213			8.0	6.0	64.0	19.0
SA-3M	41375020M	41225	41375027M	41237	41375030M	41249			9.5	6.0	64.0	19.0
SA-3NFM							41375150M	41269	9.5	6.0	64.0	19.0
SA-3MZ	41393020M	41250	41393027M	41252	41393030M	41254			10.0	6.0	65.0	20.0
SA-4M	41437520M	41281	41437527M	41293	41437530M	41305			11.0	6.0	70.0	25.0
SA-5MZ	41472020M	41262	41472027M	41264	41472030M	41266			12.0	6.0	70.0	25.0
SA-5M	41500020M	41317	41500027M	41329	41500030M	41341			12.7	6.0	70.0	25.0
SA-5NFM							41500150M	41361	12.7	6.0	70.0	25.0
SA-6M	41625020M	41373	41625027M	41385	41625030M	41397			16.0	6.0	70.0	25.0
SA-6NFM							41625150M	41417	16.0	6.0	70.0	25.0
SA-15M	41750120M	41465	41750127M	41477	41750130M	41489			19.0	6.0	58.0	12.7
SA-16M	41750220M	41501	41750227M	41513	41750230M	41525			19.0	6.0	64.0	19.0
SA-7M	41750020M	41429	41750027M	41441	41750030M	41453			19.0	6.0	70.0	25.0
SA-9M	41100020M	41009	41100027M	41021	41100030M	41033			25.0	6.0	70.0	25.0

*Diamond, fine diamond, alternate fine diamond, and chipbreaker cuts are no longer available.

